

C. 202 - 194

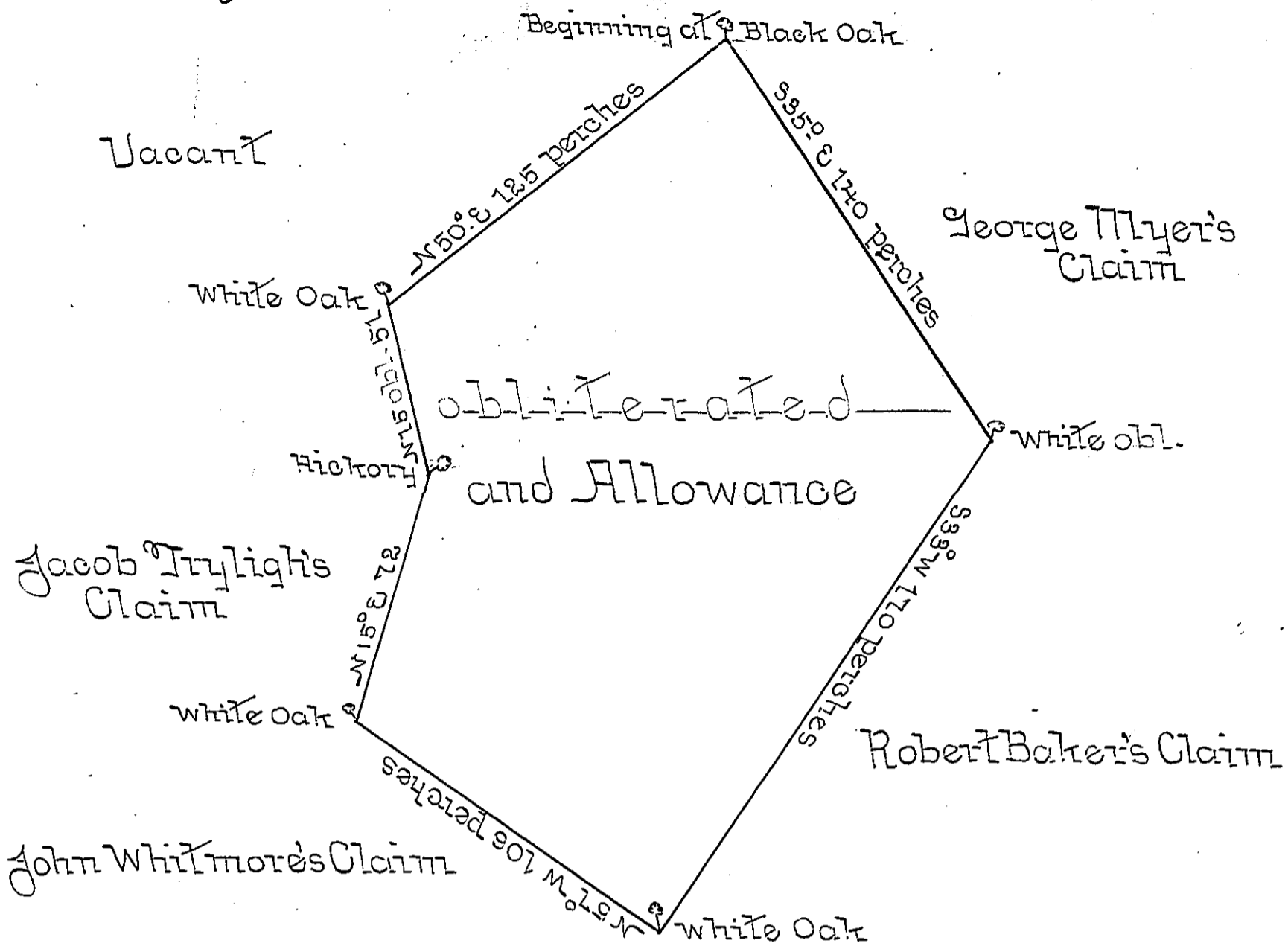

A Draught of a Tract of Land Situate in Lebanon Township in the County of Lancaster containing one Hundred and sixty four Acres and an half and the Allowance of Six Acres Percent for Roads and Highways Surveyed the 18th day of May 1744 by Thomas Cookson Esq^r late Deputy Surveyor of Lancaster County for Nicholas Orbe in pursuance of a Warrant bearing Date at Philadelphia the 10th Day of April 1744^{obl}

To William Parsons Esq^r } Sec^r Stevenson one of
 Surveyor General } the Executors of
 Tho^s Cookson Deced

IN TESTIMONY that the above is a copy of the original remaining on file in the Department of Internal Affairs of Pennsylvania, made conformably to an Act of Assembly approved the 16th day of February, 1833, I have hereunto set my Hand and caused the Seal of said Department to be affixed at Harrisburg, this

Sixth day of July 1897

James W. Pitta
 Secretary of Internal Affairs.